

VL62

Black Housing

VL62W

White Housing

Features

- Color Day/Night Camera
- Built-in 4mm Lens
- 14 IR LEDs with 32' range
- 12V power supply included

Specifications

- Image Device..... 1/4" Sony Super-HAD II
- Built-in Lens..... 4mm
- Resolution..... 420 TV Lines
- Total Pixels..... 537 (H) x 505 (V) approx. 270K pixels
- Effective Pixels..... 510 (H) x 492 (V) approx. 250K pixels
- Electronic Shutter Speed..... 1/60 - 1/100000
- Minimum Object Illumination..... 0 Lux with IR on, 0.3 Lux IR off, F 1.2
- Number of IR LED..... 14
- LED IR Wave Length..... 850 nm
- Effective IR Range..... 32'
- Video S/N Ratio..... >48dB
- Gamma..... 0.45
- Video Signal Output..... 1.0V p-p, 75 Ohms
- Scanning System..... 2:1 Interlace, EIA standard 525 line
60 fields/second
- Synchronization System..... Internal
- Back Light Compensation..... YES
- AGC..... YES
- CDS Sensor..... YES
- Operating Temperature..... 14°F - 140°F
- Storage Temperature..... -4°F - 176°F
- Operating Humidity..... 30% - 80% RH
- Power Requirement (Voltage)..... DC 12V @300mA
- Unit Construction Materials..... Plastic
- Weight..... 0.66 lbs.
- Accessories included in box..... Mounting bracket included, Power Supply

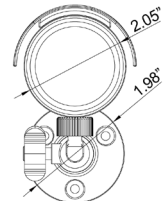
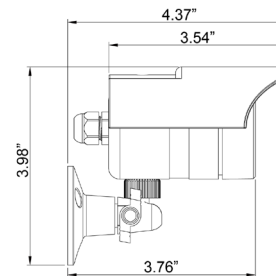
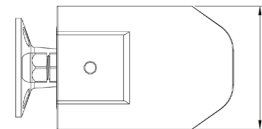
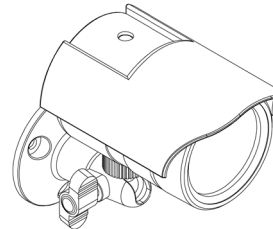

Speco Technologies is constantly developing and improving products.

We reserve the right to modify product design and specifications without notice and without incurring any obligation.

Rev. 10/4/11

For more information contact Speco Technologies

200 New Highway, Amityville, NY 11701 • Toll Free: 1-800-645-5516 • Fax: 631-957-9142 or 631-957-3880
www.specotech.com